

# Sanitary Level Transmitters

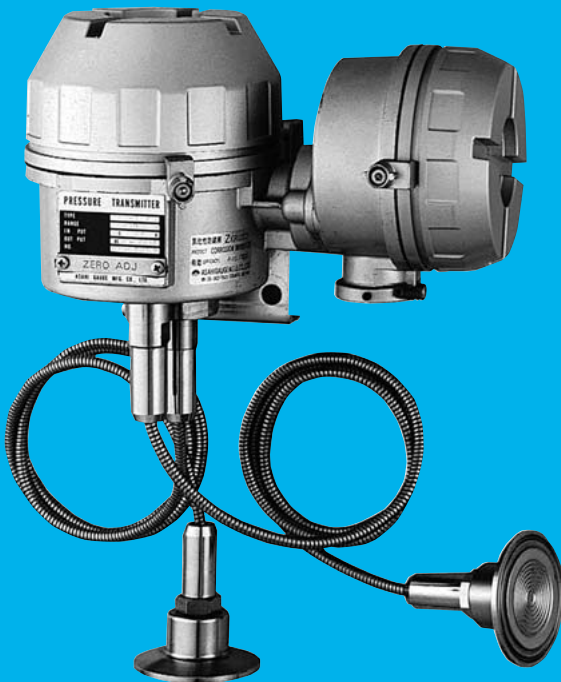





## SANITARY LEVEL TRANSMITTER

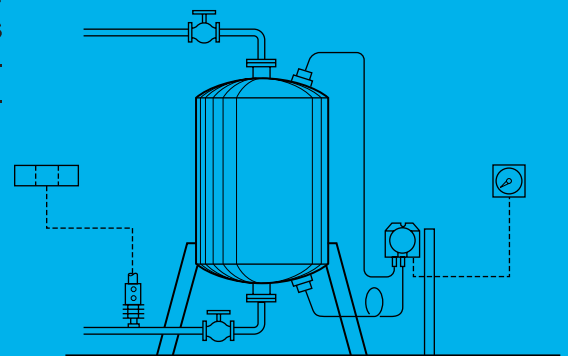

These liquid-level transmitters are admired by many users for their outstanding reliability. The application covers the food and pharmaceutical industries, as well as the manufacture of cosmetics, biotechnology products and semiconductors where the cleanliness and safety of products come first.

### Features

- Clean and safe operation.
- Harmless sealed liquid.
- Easy cleaning.
- Withstanding high temperature.
- Compact, highly reliable.

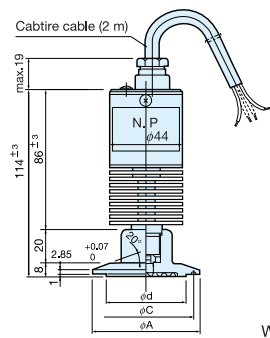
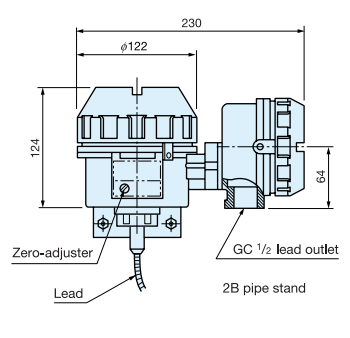
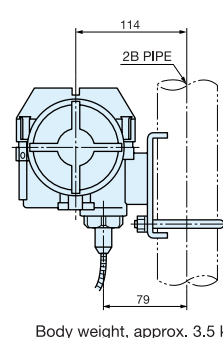

				
Application	Open tanks	Same as left.	Same as left.	Same as left.
Model	MSC-N24J	MSC-N24M	MSC-Y24J MSC-Y44J	MSC-Y24M MSC-Y44M
Pressure (differential pressure) range	0 to 20 KPa, 0 to 1 MPa	Same as left.	Same as left.	Same as left.
Allowable overpressure	150% F.S.	Same as left.	Same as left.	Same as left.
Withstanding pressure (one side)	—	—	—	—
Wet-part material	SUS316L/SUS316	Same as left.	Same as left.	Same as left.
Connection	IDF ferrule (2 S or over)	Flange (diaphragm dia. 47 mm or over)	IDF ferrule (2 S or over)	Flange (diaphragm dia. 47 mm or over)
Power supply	24±10% V DC, two-wire	Same as left.	24±10% V DC, two-wire 100/110±10% V AC, four-wire	Same as left.
Output signal	4 to 20 mA DC	Same as left.	Same as left.	Same as left.
Load resistance	MAX. 500 Ω	Same as left.	Same as left.	Same as left.
Accuracy	Not more than ±1.0% F.S./°C (at 20°C)	Same as left.	Same as left.	Same as left.
Temperature drift	2½ S > 40 Pa/°C 3 S < 30 Pa/°C	Same as left.	2½ S > 40 Pa/°C 3 S < 30 Pa/°C	40 Pa/°C
Working temperature at pressure-receiving part	-10 ~ +150°C	Same as left.	Same as left.	Same as left.
Zero-position & span adjustment	±10% F.S.	Same as left.	Same as left.	Same as left.
Suppression range	—	—	±120% F.S.	Same as left.
Capillary length	—	—	MAX. 3 m	Same as left.
Sealed liquid	Silicone oil	Same as left.	Same as left.	Same as left.
Approx. dimensions	 Weight, approx. 2 kg		 Body weight, approx. 3.5 kg	 Body weight, approx. 3.5 kg
Other	1. Waterproof SUS 304 body. 2. Flange projection (max. 150 mm) to be specified by customer. 3. Ferrule projection type (max. 150 mm) also available. 4. IDF screw and IDF nut types are also available. 5. Transmitters without radiation fins are available.		1. Drip-proof aluminium die-cast case, silver grey. 2. Case to be installed on a pipe stand or on the wall. 3. Ferrule projection type (max. 150 mm) is also available. 4. IDF screw and IDF nut types are also available. 5. Products with an allowable overpressure of 3 kg are also available.	

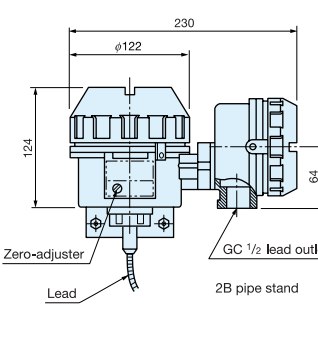
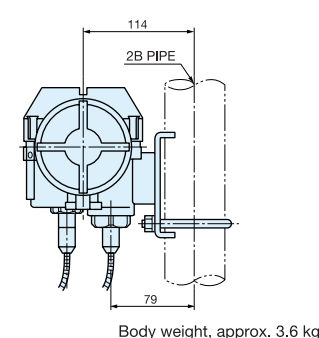
		
	(ライン圧出力必要時はご指示ください)	
Application	Closed tanks	Same as left.
Model	MDC-Y24M	MDC-Y24J MDC-Y44J
Pressure (differential pressure) range	Differential pressure, 0 to 15, 0 to 60 KPa Line pressure, 0 to 0.5 MPa	Differential pressure, 0 to 15, 0 to 60 KPa
Allowable overpressure	Line pressure, 0.65 MPa	Same as left.
Withstanding pressure (one side)	*MAX. 0.45 MPa	150% F.S.
Wet-part material	SUS316L/SUS316	Same as left.
Connection	Flange (diaphragm dia. 47 mm or over)	IDF ferrule (2 S or over)
Power supply	24±10% V DC	24±10% V DC, two-wire 100/110±10% V AC, four-wire
Output signal	Differential pressure, 4 to 20 mA DC/specified pressure (Line pressure, 4 to 20 mA DC/0 to 0.5 MPa)	4 to 20 mA DC
Load resistance	MAX. 500 Ω	Same as left.
Accuracy	Not more than ±1.0% F.S./°C (at 20°C)	Same as left.
Temperature drift	40 Pa/°C	2½ 40 Pa/°C 3 S 30 Pa/°C
Working temperature at pressure-receiving part	-10 ~ +150°C	Same as left.
Zero-position & span adjustment	±10% F.S.	Same as left.
Suppression range	±120% F.S.	Same as left.
Capillary length	max. 5 m (0 to 30 KPa and over, 7 m available)	Same as left.
Sealed liquid	Silicone oil	Same as left.
Approx. dimensions	 Body weight, approx. 3.6 kg	 Body weight, approx. 3.6 kg
Other	1. Drip-proof aluminium die-cast case, silver grey. 2. Case to be installed on a pipe stand or on the wall. 3. Ferrule projection type (max. 150 mm) is also available.. 4. IDF screw and IDF nut types are also available. * Please specify an allowable overpressure.	

## Pressure-receiving part dimensions

Ferrule connection

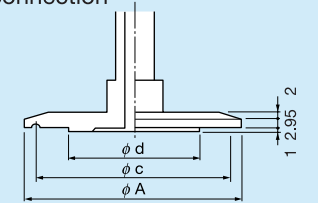

Ferrule	d	c	A
2 S	47	56.5	64
2½ S	47	70.5	77.5
3 S	72	83.5	91

Note: Projection (max. 150 mm) may be specified for the diameter 'd'.

## Examples of flange connection

Example 1

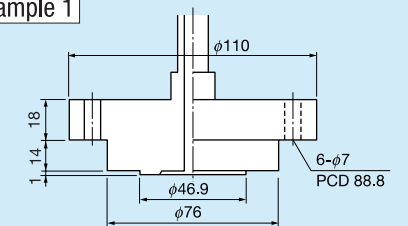

Example 2

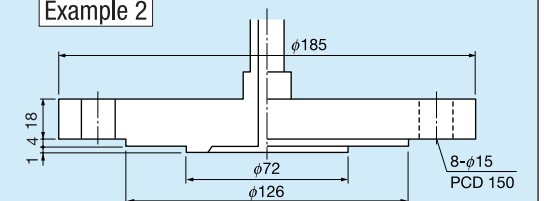

## When ordering

- Please specify **Model** - **Pressure-receiving part size** - **Lead length** - **Pressure range**. Specify a method of installation (2B pipe stand or wall) for MDC-Y or MSC-Y.
- Other types of the pressure-receiving part are custom-made.

## Receivers

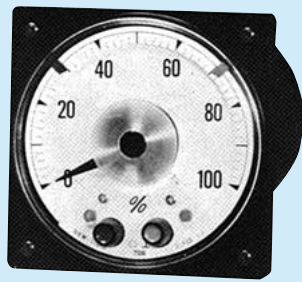
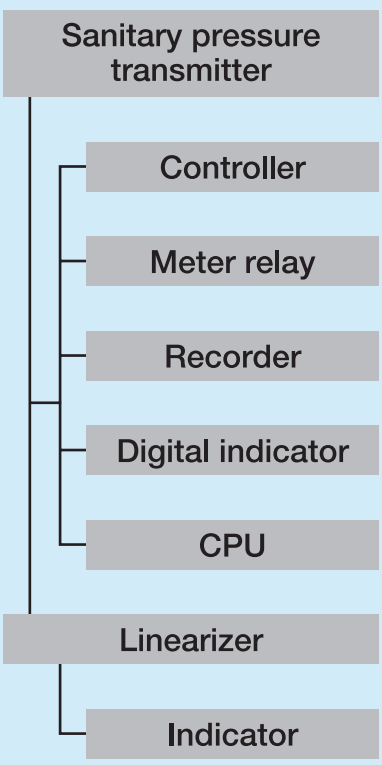
 <p>DT-5</p> <p>DM-5 with contacts</p>		<h3>Instrument combination</h3>  <pre> graph TD     A[Sanitary pressure transmitter] --- B[Controller]     A --- C[Meter relay]     A --- D[Recorder]     A --- E[Digital indicator]     A --- F[CPU]     G[Linearizer] --- H[Indicator]         </pre>
<h3>Digital panel meters</h3>	<h3>Meter relay</h3>	
<p>These instruments digitally indicate signals that they receive from a pressure or temperature detecting element.</p> <p>Input signals</p> <ul style="list-style-type: none"> <li>4 to 20 mA DC</li> <li>1 to 5 V DC</li> <li>Pt 50 Ω, 100 Ω</li> <li>Thermocouple electromotive force</li> </ul> <p>Indicator</p> <p>1999</p> <p>Red LED; character height, 12.7 mm.</p> <p>Minus (-) symbol attached for negative input.</p> <p>Alarm (DM-5 with converter)</p> <p>H/L relay contact SPDT</p> <p>125 VA AC</p> <p>Power consumption</p> <p>3.5 VA</p> <p>Internal impedance</p> <p>250 Ω when current input</p>	<p>This meter displays signals received from a pressure transmitter on a dial scale with H&amp;L contacts (two points).</p> <p>Input signals</p> <ul style="list-style-type: none"> <li>4 to 20 mA DC</li> <li>1 to 5 V DC</li> </ul> <p>Indicator</p> <ul style="list-style-type: none"> <li>• Scale central angle, 90° (eccentric) or 270° (wide angle).</li> <li>• Unit to be specified.</li> </ul> <p>Alarm</p> <p>H, HH, HL, L</p> <p>100 V AC, 1 A</p>	

A **power supply** and **distributor** for converting 100 V AC into 24 V DC are available.



Note: These specifications may be changed for improvements without notice.