

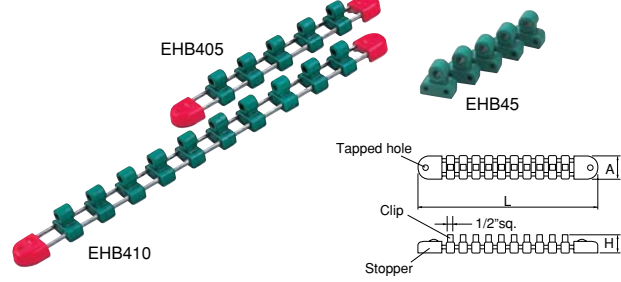

● 1/2"sq. SOCKET HOLDER • CLIP SET (5pcs.)  
D.PAT.



SOCKET HOLDER-CLIP SET (5pcs.)

No.	No. of clips	H	A	L	▼g	📦
EHB405	5	26.5	25	215	120	10
EHB410	10	26.5	25	365	150	10

• Change of holder shape enables easier insertion/removal of socket and increased holding strength compared with previous model. (Does not fall off so easily while carving)  
• The insertion angle has its own holder coloring setting.  
**CAUTION** • DO NOT OVER TORQUE, AS THE WHOLE LENGTH IS LONG ENOUGH TO APPLY EXCESSIVE LOAD.

No. EHB45	▼g 30	📦 10
Clip	5pcs.	

• Spare clip for EHB405, 410.  
• Can be used for EHB205-215 and 305-315.

● 1/2"sq. SOCKET HOLDER

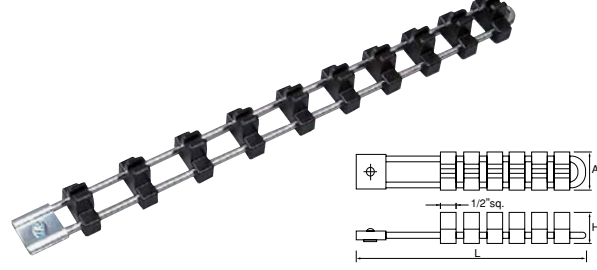

SOCKET HOLDER

No.	No. of clips	H	A	L	▼g	📦
B30 - 6R	6	24	35	195	90	5
-10R	10	24	35	320	145	5

• For managing sockets in 6pcs(B30-6R)or 10pcs(B30-10R).  
**CAUTION** • DO NOT OVER TORQUE, AS THE WHOLE LENGTH IS LONG ENOUGH TO APPLY EXCESSIVE LOAD.

● 1/2"sq. STUD REMOVER

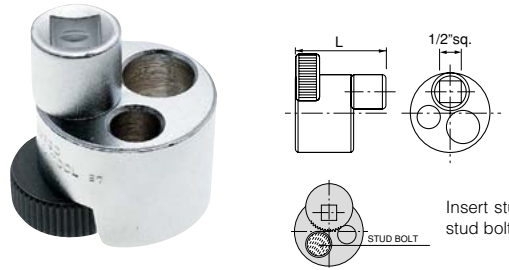

STUD REMOVER

No.	Bolt Diameter		L	▼g	📦
	Max.	Min.			
BSR30	ø19	ø6	56	400	1

• For use on stud bolts.  
\*Replacement parts are available. Check with your dealer for details.  
**CAUTION** • USE A SOCKET APPROPRIATE TO THE SIZE OF A BOLT OR NUT.

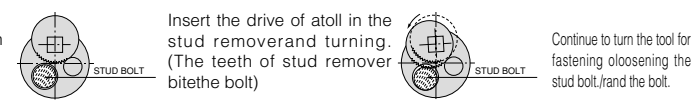

● 1/2"sq. STUD BOLT REMOVER • SET (4pcs.)



Usage  
• Removal & installation of stud bolts (Can be used on round ones as well).  
Characteristics  
• For fastening/loosening stud bolts.  
• Usable either for fastening or loosening.  
• Ratchet mechanism enables continuous operation.  
\*Do not use on stud bolts that expose less than 20mm.

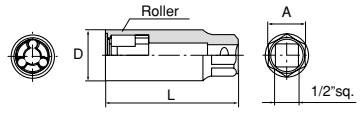

\*The A is a wrench that is shaped like a hexagon.

STUD BOLT REMOVER • SET(4pcs.)

No. BSR354	▼kg 1.1	📦 1
Stud Bolt Remover	BSR35-6, 8, 10, 12	
Metal Case	L215xW82xH50mm	

No.	D	L	S	Applicable Size	▼g	📦
BSR35 - 6	24	65	21	M 6	150	1
- 8	24	65	21	M 8	150	1
-10	28	75	21	M10	220	1
-12	28	75	21	M12	220	1

**CAUTION** • USE A SOCKET APPROPRIATE TO THE SIZE OF A BOLT OR NUT.  
• CHECK THE STUD BLOT FIRMLY CONNECTED WITH THE TOOL BEFORE APPLYING ANY POWER.

● 3/4"sq. SOCKET WRENCH SET (10pcs.)



SOCKET WRENCH SET (10pcs.) mm

No. B408	▼kg 10	📦 1
Socket (12pt.)	B40-22, 24, 27, 30, 32, 36, 41, 46	
Ratchet Handle	BR41	
Extension Bar	200	BE40-200
Metal Case	B410-M L535xW175xH85mm	

\*Contents may be changed according to the purpose of usage.

● 3/4"sq. SOCKET WRENCH SET (13pcs.)



SOCKET WRENCH SET (13pcs.) mm

No. B4008R	▼kg 13.5	📦 1
Socket (12pt.)	B40-27, 30, 32, 36, 41, 46, 50, 55	
No. B4108R	▼kg 12.5	📦 1
Socket (12pt.)	B40-26, 29, 32, 35, 38, 41, 46, 50	

Common Items		
Ratchet Handle	BR41	
Extension Bar	BE40-200, 400	
Bar	BL40	
Head	BH40	
Metal Case	B4110-M L535xW175xH85mm	

\*Equivalent to Japanese Machine Tool Standards Catalog 608ISO, however, the contents may be subject to slight differences.



**SOCKET WRENCH SET (14pcs.)** mm

<b>No. B410</b>	▼kg 13.2	📦 1
Socket (12pt.)	B40-22, 24, 27, 30, 32, 35, 36, 38, 41, 46	
Ratchet Handle	BR41	
Spinner Handle	BS40-500	
Extension Bar	130	BE40-130
	200	BE40-200
Metal Case	B410-M L535×W175×H85mm	



●3/4"sq. SOCKET WRENCH SET (14pcs.)



**SOCKET WRENCH SET (15pcs.)** mm

<b>No. B4110</b>	▼kg 16.6	📦 1
Socket (12pt.)	B40-23, 26, 29, 32,35, 38, 41, 46, 50, 54	
Ratchet Handle	BR41	
Spinner Handle	BS40-500	
Extension Bar	200	BE40-200
	400	BE40-400
Bar	BL40-500	
Head	BH40	
Metal Case	B4110-M L535×W175×H85mm	

POWERFIT (Delete unless over B40- 46)

●3/4"sq. SOCKET WRENCH SET (15pcs.)



**SOCKET WRENCH SET (18pcs.)** in

<b>No. BB413R</b>	▼kg 15.5	📦 1
Socket (12pt.) in	BB40-1-1/16, 1-1/8, 1-3/16, 1-1/4, 1-5/16, 1-3/8, 1-7/16, 1-1/2, 1-5/8, 1-3/4, 1-13/16, 1-7/8, 2	
Ratchet Handle	BR41	
Extension Bar	200	BE40-200
	400	BE40-400
Bar	BL40	
Head	BH40	
Metal Case	B408R-MA L535×W175×H85mm	

\*Equivalent to Japanese Machine Tool Standards Catalog 613, however, the contents may be subject to slight differences.

●3/4"sq. SOCKET WRENCH SET (18pcs.)



**SOCKET** mm

No.	S	D <sub>1</sub>	D <sub>2</sub>	H	L	ℓ	▼g	📦
B40 -17	17	26	33	12	46	25	160	5
-18	18	27	33	13	46	25	160	5
-19	19	27.5	33	14	46	25	160	5
-20	20	29.5	33	14	47	26	170	5
-21	21	30	33	15	47	26	170	5
-22	22	31	33	16	49	28	170	5
-23	23	32.5	33	16	49	28	170	5
-24	24	34	33	18	50	29	180	5
-25	25	35	34	19	51	30	200	5
-26	26	36.5	34	19	51	30	210	5
-27	27	38	34	19	51	30	220	5
-28	28	39	34	20	52	31	230	5
-29	29	40	34	21	53	32	240	5
-30	30	42	36	22	54	33	270	5
-31	31	43	38	23	55	34	300	5
-32	32	44	38	24	56	35	310	5
-33	33	46	38	24	57	36	340	5
-34	34	47	38	25	57	36	350	5
-35	35	48	38	26	59	38	370	5
-36	36	50	40	27	60	39	410	5
-37	37	51	40	28	61	40	430	5
-38	38	52	40	29	62	41	440	5
-39	39	54	40	30	63	42	470	5
-40	40	55	40	31	64	43	490	5
-41	41	56	40	32	65	44	500	5
-42	42	57.5	38	35	66	45	540	5
-43	43	59	40	36	67	46	590	5
-44	44	60	42	37	68	47	630	5
-45	45	62	44	37	69	48	710	5
-46	46	63	44	35	70	49	750	2
-47	47	64	44	39	71	50	780	2
-48	48	65.5	44.5	39	72	51	810	2
-50	50	68	46	42	74	53	880	2
-52	52	71	48	47	75	54	920	2
-54	54	73	48	48	76	55	950	2
-55	55	75	48	51	79	58	1,040	2
-56	56	76	48	52	80	59	1,060	2
-57	57	77	48	53	81	60	1,080	2
-58	58	79	48	53	82	61	1,180	2
-60	63	83.5	58	53	84	63	1,390	2
-63	56	76	48	52	80	59	1,060	2
-65	65	88	58	52	84	63	1,520	2
-70	70	92	58	52	84	63	1,580	2
-75	75	98.5	58	56	86	65	1,720	2
-80	80	104.5	63	59	90	69	2,040	2
-85	85	111	63	59	90	69	2,220	2

POWERFIT (Except below B40-46)

●3/4"sq. SOCKET

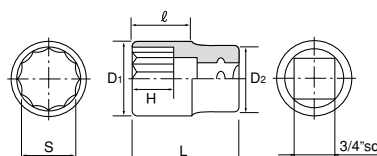

3/4" sq.

● 3/4"sq. SOCKET

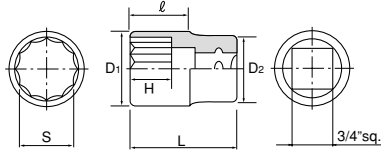

SOCKET								in	
No.	S	D <sub>1</sub>	D <sub>2</sub>	H	L	l	▼g	☞	
BB40	-1-1/16	26.9	38	34	20	51	28	230	5
	-1-1/8	28.5	40	34	21	53	30	250	5
	-1-3/16	30.1	42	36	22	54	31	280	5
	-1-1/4	31.7	44	38	24	56	33	300	5
	-1-5/16	33.3	47	38	25	58	34	338	5
	-1-3/8	34.9	48	38	26	59	36	340	5
	-1-7/16	36.5	50	40	27	60	37	360	5
	-1-1/2	38.1	52	40	29	62	39	480	5
	-1-5/8	41.2	56	37	32	65	44	500	5
	-1-3/4	44.4	61	43	34	68	47	660	5
	-1-13/16	46.0	63	44	35	70	49	740	5
	-1-7/8	47.6	65	44	36	71	50	780	5
	-2	50.8	69	47	38	75	54	960	5

● 3/4"sq. RATCHET HANDLE

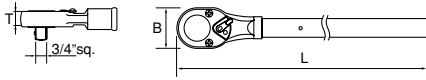
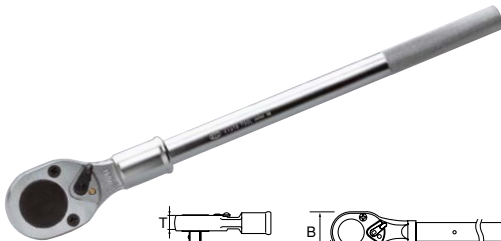

RATCHET HANDLE								
No.	Type	Feed	B	T	L	▼kg	☞	
BR41	Oval Head	15°	69	25.5	500	2.2	1	

- Standard flat head type ratchet handle.
- 24 teeth gear with 15° increments.
- Replacement parts are available. Check with your dealer for details.
- ⚠ CAUTION • ENSURE THAT THE SWITCH LEVER HAS BEEN SET PROPERLY, OTHERWISE IT MAY CAUSE DAMAGE OR IDLING.

● 3/4"sq. RATCHET HANDLE (ROUND HEAD)

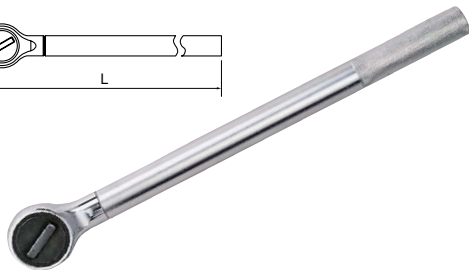
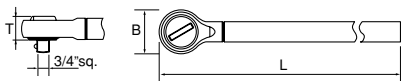

RATCHET HANDLE (ROUND HEAD)								
No.	Type	Feed	B	T	L	▼kg	☞	
BRM40	Round Head	6°	67	36	500	2.37	1	

- Round head with compact design.
- 60 teeth gear with small 6° increments.
- Replacement parts are available. Check with your dealer for details.
- ⚠ CAUTION • ENSURE THAT THE SWITCH LEVER HAS BEEN SET PROPERLY, OTHERWISE IT MAY CAUSE DAMAGE OR IDLING.

● 3/4"sq. SPINNER HANDLE • L SHAPE HANDLE

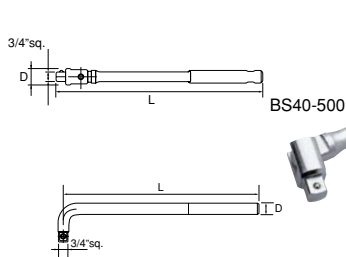

SPINNER HANDLE					
No.	D	L	▼kg	☞	
BS40-500	40	500	2	1	

- ⚠ CAUTION • HOLD GRIP IN THE CENTER, OTHERWISE HAND MAY BE CAUGHT IN THE DRIVING SECTION.
- DO NOT OVER TORQUE, AS THE WHOLE LENGTH IS LONG ENOUGH TO APPLY EXCESSIVE LOAD.

L SHAPE HANDLE					
No.	D	L	▼kg	☞	
BO40-320	24	315	1.5	2	

- ⚠ CAUTION • DO NOT OVER TORQUE, AS THE WHOLE LENGTH IS LONG ENOUGH TO APPLY EXCESSIVE LOAD.

● 3/4"sq. HEAD • BAR

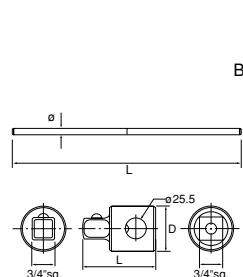

HEAD					
No.	D	L	▼g	☞	
BH40	40	71	300	1	

- ⚠ CAUTION • ALWAYS USE THE DESIGNATED BAR (No. BL40, BL40-500).

BAR					
No.	L	ø	▼kg	☞	
BL40	500	25	1.38	1	
BL40-500	500	25	1.9	1	

- For use with BH40.
- The BL40 employs a succession system which makes it compact after use.

\*Please check the merchandise inventory for a product that is marked by ⚠ before placing an order.

**EXTRA-LONG SPINNER HANDLE**

No.	D	L	A	▼kg	☒
BS6-1050	38	1000	10	3.7	1

- Is suitable for construction machinery and in large sized vehicles where high torque is necessary.
- ⚠️ **CAUTION** • HOLD GRIP IN THE CENTER, OTHERWISE HAND MAY BE CAUGHT IN THE DRIVING SECTION.
- DO NOT OVER TORQUE, AS THE WHOLE LENGTH IS LONG ENOUGH TO APPLY EXCESSIVE LOAD.

**Drive set PAT.P.**

No.	Drive	Contents
BS6-K	3/4"sq.	Drive head ASSY · Pin · Steel ball · Spring · Hexagon shaped hole fitted stop screw · Exchangeable jig · Exchangeable 6 hexagon shaped pole wrench x1

● 3/4"sq. EXTRA-LONG SPINNER HANDLE PAT.P.

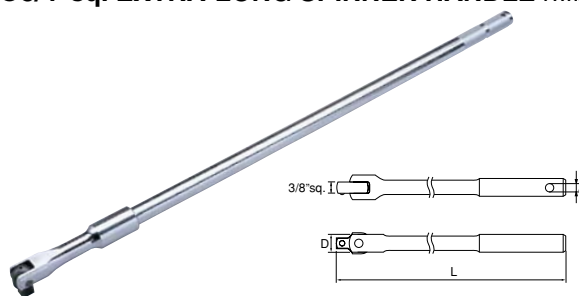

**EXTENSION BAR**

No.	D <sub>1</sub>	D <sub>2</sub>	L	▼g	☒
BE40 - 75	25	34	75	230	1
- 130	25	34	130	500	1
- 200	25	34	200	800	1
- 400	25	34	400	1,600	1

- ⚠️ **CAUTION** • DO NO EXTEND WITH 2 OR MORE BARS.

● 3/4"sq. EXTENSION BAR

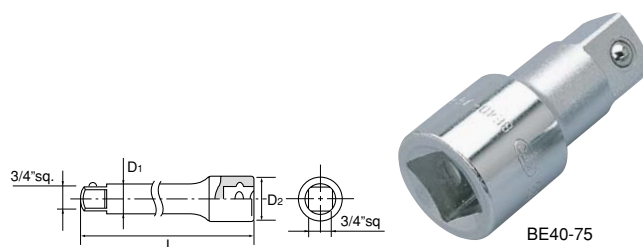

**SOCKET ADAPTOR**

No.	sq.		D	L	▼g	☒
	☐	☒				
BA4030	19.0	12.7	34	43	154	10

- ⚠️ **CAUTION** • FOR MAXIMUM TORQUE OF THE ADAPTOR, REFER TO THE SMALLER SIZE, DO NOT APPLY EXCESSIVE POWER. DO NOT APPLY EXCESSIVE PRESSURE.

● 3/4"sq. SOCKET ADAPTOR

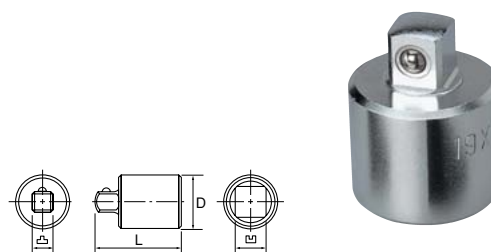

**SOCKET** mm

No.	S	D <sub>1</sub>	D <sub>2</sub>	H	L	ℓ	▼g	☒
B50 -27	27	40.5	44	19	60	31	370	1
-30	30	44	44	21	65	36	410	1
-32	32	46.5	44	23	65	36	430	1
-33	33	48	48	23.5	65	36	510	1
-35	35	50.5	48	24.5	65	36	530	1
-36	36	54	52	30	72	43	720	1
-38	38	54	52	32	74	45	710	1
-40	40	56.5	52	33	76	47	750	1
-41	41	60	52	34	77	48	850	1
-42	42	59	56	35	79	50	810	1
-46	46	66	52	40	82	53	980	1
-50	50	71	56	43	86	57	1,200	1
-54	54	74	56	46	90	61	1,270	1
-55	55	78	56	48	92	63	1,430	1
-58	58	79	56	50	94	65	1,370	1
-60	60	84	56	52	98	69	1,660	1
-63	63	88	60	56	103	74	1,980	1
-65	65	91	60	58	103	74	2,170	1
-67	67	94	60	59	108	79	2,360	1
-68	68	94	60	59	109	80	2,410	1
-70	70	97	60	60	111	82	2,480	1
-71	71	97	65	63	113	84	2,500	1
-75	75	104	65	66	118	89	3,050	1
-77	77	107	65	67	120	91	3,260	1
-80	80	110	65	70	124	95	3,450	1
-83	83	110.5	65	72	127	98	3,610	1
-85	85	117	70	75	130	101	4,170	1
-90	90	119	75	78	130	101	4,370	1
-95	95	125.5	85	76	130	101	4,800	1
-100	100	131.5	85	75	130	101	5,200	1

● 1"sq. SOCKET

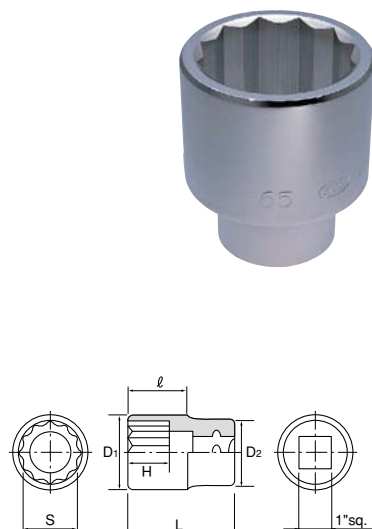

**RATCHET HANDLE**

No.	Type	B	T	L	Feed	▼kg	☒
BR50	Oval Head	68	31.5	715	15°	3.13	1

- Standard flat head type ratchet handle.
- 24 teeth gear with 15° increments for smooth movement.
- \*Replacement parts are available. Check with your dealer for details.
- ⚠️ **CAUTION** • ENSURE THAT THE SWITCH LEVER HAS BEEN SET PROPERLY, OTHERWISE IT MAY CAUSE DAMAGE OR IDLING.

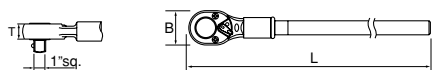

● 1"sq. RATCHET HENDLE

