

## 2. CONVENTIONAL TOOLS

# ADJUSTABLE WRENCHES, PIPE WRENCHES and GEAR PULLERS



### CAUTION

#### Adjustable wrenches

- Firmly adjust the mouth to the width of the bolts and nuts.
- Turn towards the lower jaw.
- Do not use by adding on pipes, etc.
- Do not use this tool as a hammer.
- Do not apply strong impact on this tool by hitting it with a hammer, etc.

#### Pipe wrenches

- Use this tool within the range of the outer diameter of the pipe being held.
- Firmly hold the wrench perpendicular to the pipe and hold firmly at the center.
- Do not apply force sideways.
- Do not use by adding on pipes, etc.
- Do not use this tool as a hammer.
- Do not apply strong impact on this tool by hitting it with a hammer, etc.
- Do not use when the teeth are chipped or worn, or when blocking has occurred.

### ● ADJUSTABLE WRENCH

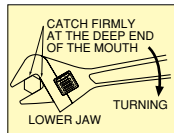

ADJUSTABLE WRENCH									
No.	Nominal	Opening	T <sub>1</sub>	T <sub>2</sub>	B	L	▼g	☞	
WM-150	150	25	5.5	11	51.7	164.5	140	10	
-200	200	30	6.5	13	63.5	213	240	10	
-250	250	35	8.5	14.5	75	263	380	10	
-300	300	43	10	18.5	91.5	316	670	5	

### ● ADJUSTABLE WRENCH

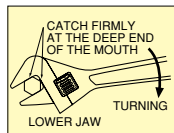

ADJUSTABLE WRENCH									
No.	Nominal	Opening	T <sub>1</sub>	T <sub>2</sub>	L	▼g	☞		
MWA-150	150	20	6.7	11	158	120	6		
-200	200	24	7.5	12.9	208	235	6		
-250	250	29	8.7	15.32	258	380	6		
-300	300	34	10.2	18.24	308	590	6		
-375	375	44	13.4	23.5	375	1,300	1		
-450	450	55	14	25.6	450	2,200	1		

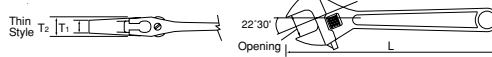

### ● PIPE WRENCH

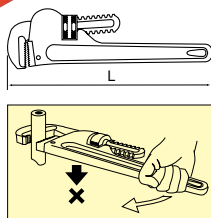
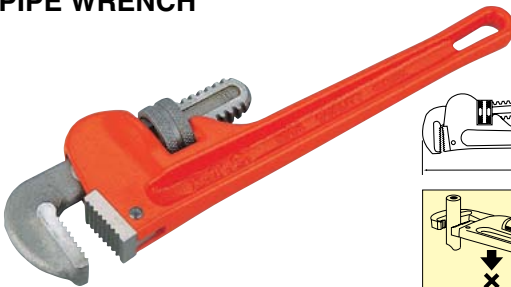

PIPE WRENCH						
No.	Nominal	Max. Dia. of Pipe	L	▼g	☞	
PWA-150	150(6")	3/4"(19)	150	185	6	
-200	200(8")	3/4"(20)	185	350	5	
-250	250(10")	1"(26)	245	750	5	
-300	300(12")	1 1/4"(32)	300	1,100	5	
-350	350(14")	1 1/2"(38)	325	1,300	5	
-450	450(18")	2"(52)	410	2,100	5	
-600	600(24")	2 1/2"(65)	540	3,800	1	
-900	900(36")	3 3/4"(95)	780	7,300	1	

- Upper jaw screws have trapezoidal shape and are processed using a non-oxidizing heat-treatment to enhance strength and endurance.
- Upper and lower jaws have well-engaging teeth and are processed with induction heat-treatment for superior strength.

### ● ALUMINUM PIPE WRENCH

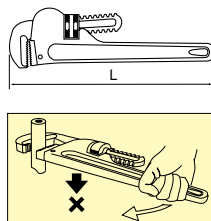

ALUMINUM PIPE WRENCH						JIS
No.	Nominal	Max. Dia. of Pipe	L	▼g	☞	
APWA-350	350(14")	1 1/2"(38)	325	1,000	5	
-450	430(18")	2"(52)	400	1,600	5	
-600	600(24")	2 1/2"(65)	550	2,500	1	

- Extra light body made of specially selected aluminum alloy.
- Highly accurate and rugged enough to pass U.S. Federal standards.

\*Please check the merchandise inventory for a product that is marked by before placing an order.

**GEAR PULLER**

No.	D - Diameter of Subject		t - Width of Subject (when D is max.)	H Claw Span	B Screw Hexagon	Breaking Load ton	▽g	📦	
	Min	Max							
GU- 75	40	75	30	55	14	2	385	1	
-100	50	100	45	70	17	4	800	1	
-150	60	150	60	100	19	6	1,862	1	

• Can be used both outer and inner diameter by reversing the claws  
 \*Replacement parts are available. Check with your dealer for details.

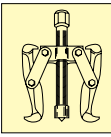

● GEAR PULLER

