

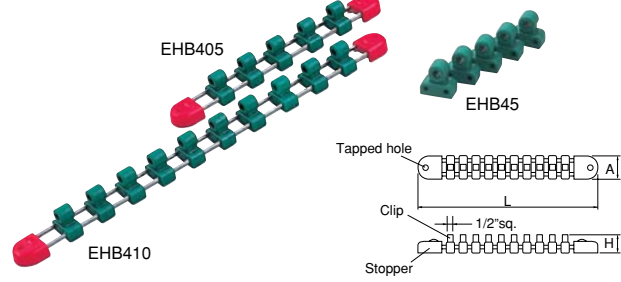

● 1/2"sq. SOCKET HOLDER • CLIP SET (5pcs.)
D.PAT.



SOCKET HOLDER-CLIP SET (5pcs.)

No.	No. of clips	H	A	L	▼g	📦
EHB405	5	26.5	25	215	120	10
EHB410	10	26.5	25	365	150	10

• Change of holder shape enables easier insertion/removal of socket and increased holing strength compared with previous model. (Does not fall off so easily while carving)
• The insertion angle has its own holder coloring setting.
CAUTION • DO NOT OVER TORQUE, AS THE WHOLE LENGTH IS LONG ENOUGH TO APPLY EXCESSIVE LOAD.

No. EHB45	▼g 30	📦 10
Clip	5pcs.	

• Spare clip for EHB405, 410.
• Can be used for EHB205-215 and 305-315.

● 1/2"sq. SOCKET HOLDER

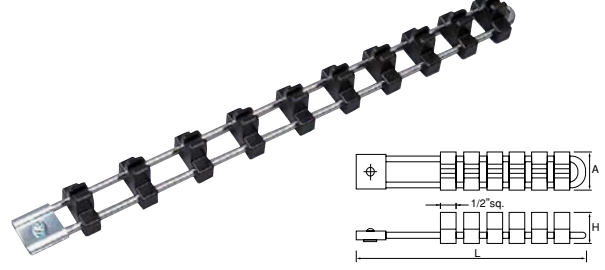

SOCKET HOLDER

No.	No. of clips	H	A	L	▼g	📦
B30 - 6R	6	24	35	195	90	5
-10R	10	24	35	320	145	5

• For managing sockets in 6pcs(B30-6R)or 10pcs(B30-10R).
CAUTION • DO NOT OVER TORQUE, AS THE WHOLE LENGTH IS LONG ENOUGH TO APPLY EXCESSIVE LOAD.

● 1/2"sq. STUD REMOVER

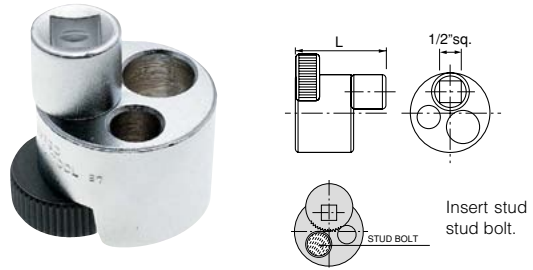

STUD REMOVER

No.	Bolt Diameter		L	▼g	📦
	Max.	Min.			
BSR30	ø19	ø6	56	400	1

• For use on stud bolts.
*Replacement parts are available. Check with your dealer for details.
CAUTION • USE A SOCKET APPROPRIATE TO THE SIZE OF A BOLT OR NUT.

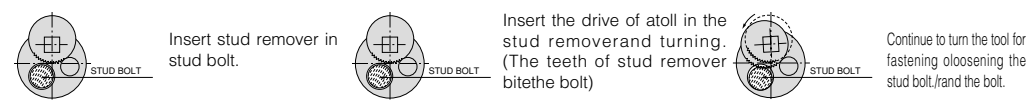

● 1/2"sq. STUD BOLT REMOVER • SET (4pcs.)



Usage
• Removal & installation of stud bolts (Can be used on round ones as well).
Characteristics
• For fastening/loosening stud bolts.
• Usable either for fastening or loosening.
• Ratchet mechanism enables continuous operation.
*Do not use on stud bolts that expose less than 20mm.

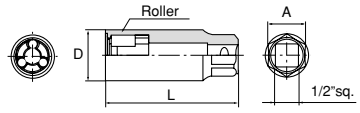

*The A is a wrench that is shaped like a hexagon.

STUD BOLT REMOVER • SET(4pcs.)

No. BSR354	▼kg 1.1	📦 1
Stud Bolt Remover	BSR35-6, 8, 10, 12	
Metal Case	L215xW82xH50mm	

No.	D	L	S	Applicable Size	▼g	📦
BSR35 - 6	24	65	21	M 6	150	1
- 8	24	65	21	M 8	150	1
-10	28	75	21	M10	220	1
-12	28	75	21	M12	220	1

CAUTION • USE A SOCKET APPROPRIATE TO THE SIZE OF A BOLT OR NUT.
• CHECK THE STUD BLOT FIRMLY CONNECTED WITH THE TOOL BEFORE APPLYING ANY POWER.

● 3/4"sq. SOCKET WRENCH SET (10pcs.)



SOCKET WRENCH SET (10pcs.) mm

No. B408	▼kg 10	📦 1
Socket (12pt.)	B40-22, 24, 27, 30, 32, 36, 41, 46	
Ratchet Handle	BR41	
Extension Bar	200	BE40-200
Metal Case	B410-M L535xW175xH85mm	

*Contents may be changed according to the purpose of usage.

● 3/4"sq. SOCKET WRENCH SET (13pcs.)



SOCKET WRENCH SET (13pcs.) mm

No. B4008R	▼kg 13.5	📦 1
Socket (12pt.)	B40-27, 30, 32, 36, 41, 46, 50, 55	
No. B4108R	▼kg 12.5	📦 1
Socket (12pt.)	B40-26, 29, 32, 35, 38, 41, 46, 50	

Common Items		
Ratchet Handle	BR41	
Extension Bar	BE40-200, 400	
Bar	BL40	
Head	BH40	
Metal Case	B4110-M L535xW175xH85mm	

*Equivalent to Japanese Machine Tool Standards Catalog 608ISO, however, the contents may be subject to slight differences.



GEAR PULLER

No.	D - Diameter of Subject		t - Width of Subject (when D is max.)	H Claw Span	B Screw Hexagon	Breaking Load ton	▽g	📦	
	Min	Max							
GU- 75	40	75	30	55	14	2	385	1	
-100	50	100	45	70	17	4	800	1	
-150	60	150	60	100	19	6	1,862	1	

• Can be used both outer and inner diameter by reversing the claws
 *Replacement parts are available. Check with your dealer for details.

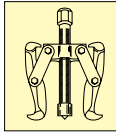

● GEAR PULLER

