

(SKX5206 TOP SPACE SIZE)

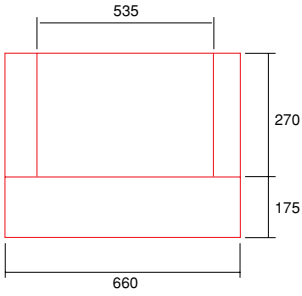

SKX5206



SKX5714



SKX5706

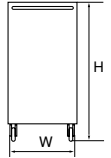
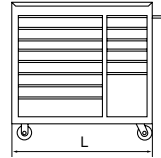
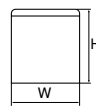
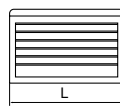
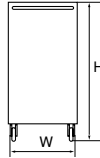
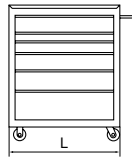
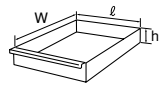

SKX5000 SERIES

●CHEST (6-DRAWER)

No. **SKX5206** ▼kg 42 1

- Size L665×W450×H500
- Drawer size
  - ℓ 565×w395×h 90×2
  - ℓ 565×w400×h60×1
- Drawer divider x4 • Middle-sized tray x1 • Drawer Liner x6



• The permissible load for each drawer is up to 23kg.

●ROLLER CABINET (6-DRAWER)

No. **SKX5706** ▼kg 48 1

- Size L675×W460×H880
- Drawer size
  - ℓ 565×w395×h 90×2
  - ℓ 565×w395×h 35×1
  - ℓ 565×w395×h 60×2
  - ℓ 565×w395×h145×1
- Drawer divider Large x2 • Small x2 • Top Liner x1 • Drawer Liner x6



• The permissible load for each drawer is up to 23kg.  
 • Maximum permissible load is 500kg (including product weight).

●ROLLER CABINET (14-DRAWER)

No. **SKX5714** ▼kg 110 1

- Size L1040×W460×H1045
- Drawer size
  - Left ℓ 565×w395×h 90×1
  - Left ℓ 565×w395×h 60×6
  - Left ℓ 565×w395×h145×1
  - Right ℓ 290×w395×h 90×1
  - Right ℓ 290×w395×h 60×4
  - Right ℓ 290×w395×h310×1
- Drawer divider Large x2 • Small x2 • Drawer Liner Large x8 • Small x5



• The permissible load for each drawer is up to 23kg.  
 • Maximum permissible load is 500kg (including product weight).

\*Replacement parts are available. Check with your dealer for details \*Refer to P.308 for methods on removing the drawer.

• **Special locking system**  
 Special locking system to lock all drawers with a single key action.

• **Large castors**  
 ø125×50 hard rubber castor for quiet and smooth moving.

• **Flat handles**  
 The handles on the chest are designed to be flat; convenient for use in limited space.



• SKX5205 - 5206



• SKX5706 - 5708 - 5714



• SKX5205 - 5206

〈SKX3209 TOP SPACE SIZE〉

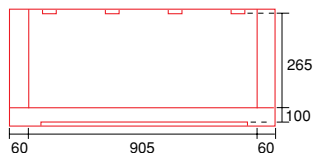

〈SKX3206 TOP SPACE SIZE〉

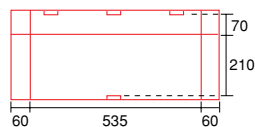

SKX3209



SKX3206



SKX3705

SKX3712

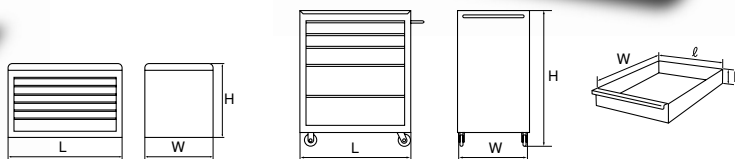

## SKX3000 SERIES

### ●CHEST (9-DRAWER)

No. <b>SKX3209</b>	▼kg 47	📦 1	 
• Size	L1030×W405×H505		
• Drawer size	Left ℓ 170×w395×h 50×3		 
	Left ℓ 565×w395×h 80×1		
	Left ℓ 565×w395×h105×2		
	Right ℓ 290×w395×h130×1		
	Right ℓ 290×w395×h105×2		
• Tray ×1 • Drawer Liner Large×3 • Middle×3 • Small×3			
• The permissible load for each drawer is up to 15kg.			

### ●ROLLER CABINET (12-DRAWER)

No. <b>SKX3712</b>	▼kg 95	📦 1	 
• Size	L1040×W465×H960		
• Drawer size	Left ℓ 565×w415×h105×1		 
	Left ℓ 565×w415×h 80×5		
	Left ℓ 565×w415×h160×1		
	Right ℓ 295×w415×h105×1		
	Right ℓ 295×w415×h 80×3		
	Right ℓ 295×w415×h325×1		
• Top liner ×1 • Drawer Liner Large×7 • Small×5			
• The permissible load for each drawer is up to 15kg.			
• Maximum permissible load is 260kg (including product weight).			
*Replacement parts are available. Check with your dealer for details *Refer to P.308 for methods on removing the drawer.			

### ●CHEST (6-DRAWER)

No. <b>SKX3206</b>	▼kg 20	📦 1	 	
• Size	L665×W305×H390			
• Drawer size	ℓ 170×w275×h 50×3		 	
	ℓ 570×w275×h 50×2			
	ℓ 570×w275×h 80×1			
• Drawer Liner Large×3 • Small×3				
This model supercedes the SKX3106				
• The permissible load for each drawer is up to 15kg.				

### ●ROLLER CABINET (5-DRAWER)

No. <b>SKX3705</b>	▼kg 47	📦 1	 	
• Size	L675×W460×H880			
• Drawer size	ℓ 570×w420×h 80×2		 	
	ℓ 570×w420×h105×1			
	ℓ 570×w420×h160×2			
• Top liner ×1 • Drawer Liner Large ×5				
This model supercedes the SKX3605				
• The permissible load for each drawer is up to 15kg.				
• Maximum permissible load is 260kg (including product weight).				

#### • Rails with ball bearings

The drawer can be pulled out. No blind corners. The double suspension rails allow smooth drawer movement.



• Common to the SKX3000 Series

#### • Easy-to-grip pipe form handle

The easy-to-grip handle makes positioning easy when transporting.



• SKX3705 - 3712

#### • Resin grip side handle provides soft touch to the hand



• SKX3206 - 3209

#### • Large castors

ø125×50 head rubber castor for quiet and smooth moving.



• SKX3705 - 3712

\*Please check the merchandise inventory for a product that is marked by before placing an order.



SKX2512



SKX2613



SKX2513



SKX2614

(SKX2614 TOP SPACE SIZE)

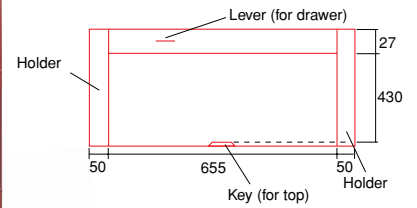

## SKX2000 SERIES

### WAGON (2-LAYER)

No. **SKX2512** ▼kg 14 1

- Size L670×W460×H375
- Large diameter castor (100×50mm) has been employed
- Wide and large castors for stable moving. All castors are free way castors with stoppers for smooth movement and safety locking.
- Wide handle Case-width big handle for easy gripping and moving.
- The customer is to assemble the unit after purchase

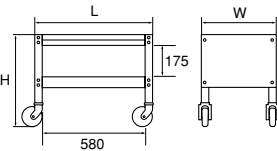

### WAGON (3-LAYER)

No. **SKX2513** ▼kg 22 1

- Size L670×W460×H900
- Convenient punched panel in one side can be used for multi purposes. Large castors
- Large diameter castor (100×50mm) has been employed
- Wide and large castors for stable moving. All castors are free way castors with stoppers for smooth movement and safety locking.
- The customer is to assemble the unit after purchase

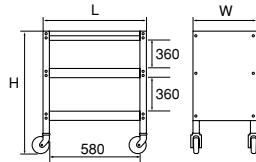

### WAGON (1-DRAWER)

No. **SKX2613** ▼kg 24 1

- Size L715×W410×H880
- Drawer size ø 570×w275×h65×1
- Top liner ×1 • Drawer Liner ×1 • Tray liner×2



- The package includes a stopper equipped free castor (2 units) and fixed castor (2 units). (ø100×30mm)
- Chests can be laid over top. The SKX0203, SKX1202, SKX1203, and the SKX3206 can be laid over the top plate.
- The customer is to assemble the unit after purchase

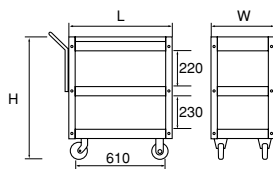

### WAGON (2-DRAWER)

No. **SKX2614** ▼kg 48 1

- Size L775×W515×H880
- Drawer size ø 630×w445×h65×2
- Top liner ×1 • Drawer Liner ×2 • Tray liner ×1



- All castors are free rotating castors (2 with stoppers) (ø100×30mm)
- The top can be opened to store tools. Both sides have holders for storing driver tools etc.
- 2 step locking system The drawer locks can be operated through the lever within the top, and the top section can be locked using keys.
- The customer is to assemble the unit after purchase



(Top is open)  
\*Tools are sold separately.

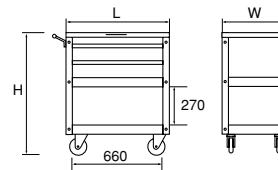

#### Drawer removal method

The drawer can be removed by pressing the release buttons on both sides of the drawer.

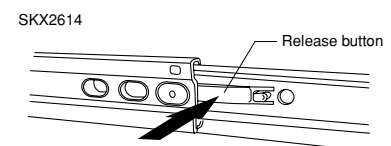
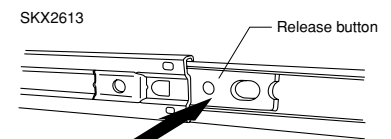

\*Replacement parts are available. Check with your dealer for details.

\*Please check the merchandise inventory for a product that is marked by before placing an order.



SKX1202



SKX0213



SKX1110



SKX1203



SKX0213S



SKX0213BK



SKX1010

## SKX1000 SERIES

### ● CHEST (3-DRAWER)

No. <b>SKX0213</b> (Solid Red)	▼kg 11	📦 1
No. <b>SKX0213S</b> (Metallic Silver)	▼kg 11	📦 1
No. <b>SKX0213BK</b> (Solid Black)	▼kg 11	📦 1

- Size L520×W215×H300
- Top space ℓ 500×w200×h60
- Drawer size ℓ 455×w190×h45
- Top Liner×1 • Drawer Liner×3 • Drawer divider×3



• Maximum storage capacity in a compact size.  
 This storage unit has a large capacity while being compact, and is equipped with a side handle that makes transporting easier.  
 \*Replacement parts are available. Check with your dealer for details

### ● CHEST (2-DRAWER)

No. <b>SKX1202</b>	▼kg 8	📦 1
--------------------	-------	-----

- Size L520×W220×H240
- Top space ℓ 510×w205×h65
- Drawer size ℓ 453×w205×h45×2
- Top liner×1 • Drawer Liner×2 • Drawer divider×4

• Maximum storage capacity in a compact size.  
 This storage unit has a large capacity while being compact, and is equipped with a side handle that makes transporting easier.

\*Replacement parts are available. Check with your dealer for details

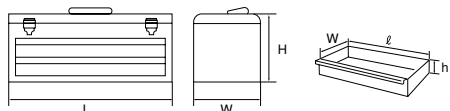

### ● CHEST (3-DRAWER)

No. <b>SKX1203</b>	▼kg 10	📦 1
--------------------	--------	-----

- Size L520×W220×H305
- Top space ℓ 510×w205×h65
- Drawer size ℓ 453×w205×h45×3
- Top liner ×1 • Drawer Liner×3 • Drawer divider×6

• Maximum storage capacity in a compact size.  
 This storage unit has a large capacity while being compact, and is equipped with a side handle that makes transporting easier.

\*Replacement parts are available. Check with your dealer for details

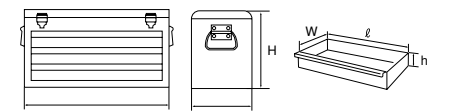

Bearing rails that allow for smooth opening and closing of drawers are equipped to the unit.

A KTC logo has been embossed on the top. (only SKX0203S)

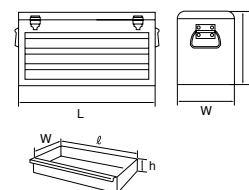

### ● TOOL BOX

No. <b>SKX1110</b>	▼kg 2.1	📦 1
--------------------	---------	-----

- Size L405×W180×H190
- Tray Size ℓ 390×w150×h70

• Tool box for multi purposes.  
 • Good for storing your collections (hobby)  
 • With tray.

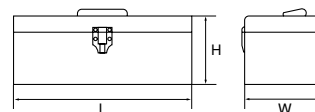

### ● TOOL BOX

No. <b>SKX1010</b>	▼kg 4	📦 1
--------------------	-------	-----

- Size L505×W180×H205
- Tray Size ℓ 480×w155×h100

• Semicylindrical shape tool box.  
 • With big tray for easy carrying.

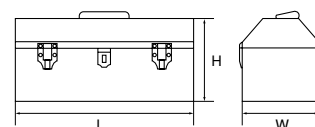

#### • Drawer removal method SKX0203

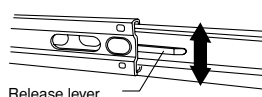

The lock is released by moving up/down the release lever on both sides of the drawer, allowing the drawer to be removed.

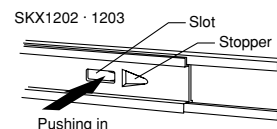

Fully pull out the drawers and then push in the notch from both drawer rail slots. The drawers can then be removed.