

STEERING

Drive shaft disassembling/assembling

1 Removing wheel
① Removing Wheel Cap

● WHEEL CAP WRENCH



➔ P.217

● ALUMINUM WHEEL CENTER CAP WRENCH



➔ P.217

● OTHER TOOLS

① Removing Wheel Nuts

● IMPACT WRENCH



➔ P.166

● WHEEL NUT SOCKET FOR IMPACT WRENCH



➔ P.218

● CROSS RIM WRENCH



➔ P.119

● OTHER TOOLS

2 Removing tie rod



● TIE ROD END SEPARATOR (OFFSET TYPE)

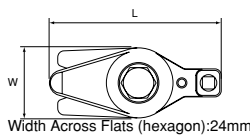

TIE ROD END SEPARATOR

No.	L	W	H	▼kg	📦
AS201	135	55	116	1.6	1

Purpose

- Separating tie rod end.

Features

- Tough! Power increased!
 - Rated output power.15kN(1.5t), maximum power, 30kN(3t)
 - Applicable to larger output power compared with former model (BJU-1945).
- High Durability Design
 - Durability enhanced by offset shape.
- Fits various vehicle models
 - Range of opening: 16mm-50mm
 - Applicable tie rod end: from mini cars to large passenger cars (3L)
- Easy operation raises work efficiency.
 - Use of thrust bolt alone enables easy installation and removal of tie rod end.
 - Smooth job using with a drive tool.
 - Square drive (3/8"sq.) adopted. Can hold counterforce of driving tool.

Application Table

Object	Models	Mini Cars	Compact Cars
Tie Rod End		●	●
Suspension	Upper	●	△
	Lower	×	×



● BALL JOINT SEPARATOR (OFFSET TYPE)

PAT. P

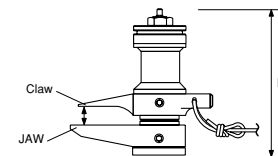
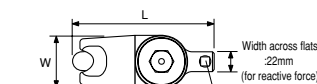

BALL JOINT SEPARATOR (OFFSET TYPE)

No.	L	W	H	▼kg	📦
AS202A	165	70	160-200	3.0	1

Application Table

Object	Models	Mini Cars	Compact Cars
Tie Rod End		●	●
Suspension	Upper	●	●
	Lower	●	×

Purpose

- Separating ball joint.

Features

- Study design of the rated output, 2.5t
- Use of thrust bolt alone permits removal and pulling out of rod end.
- Smooth job using with a drive tool.
- Square drive (3/8"sq.) used. Can hold counterforce of driving tool.

● Spare parts

No.	Name	▼kg	📦
AS202-A24	Claw	0.7	1
AS202-J	Jaw	0.7	1

3 Removing pitman arm



● PITMAN ARM PULLER

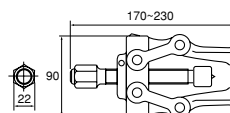

PITMAN ARM PULLER

No.	Application	▼kg	📦
PAU-3747	Mini & Compact cars, trucks & tractors	1.5	1

Usage

- Pulls of pitman arm from center shaft quite easily.
- Forged claws with proper heat-treatment.
- A cord supplied for tying to prevent fall off.
- Fastening and claws will contact deeply to inside.

Application

- Pitman outer diameter $\phi 37 \sim \phi 47$